

PICNIC TABLE

MODEL #4214-08 ADA TABLE: 8' TOP & 8' SEATS

SPECIFICATIONS:

LEG FRAME: One piece welded construction 2-3/8" O.D. Galvanized steel frame with welded angles.

TABLE TOP & SEATS: 10 GA. 2 3/8" Galvanneal Sheet bolted to a steel tube frame.

BRACE PIPE: Formed from 1-5/8" O.D. galvanized steel.

HARDWARE: All hardware is zinc-plated for long, rust-resistant service.

FINISH: Super durable polyester powder coat. (For Powder Coat colors see back-inside cover of PW ATHLETIC CATALOG.)

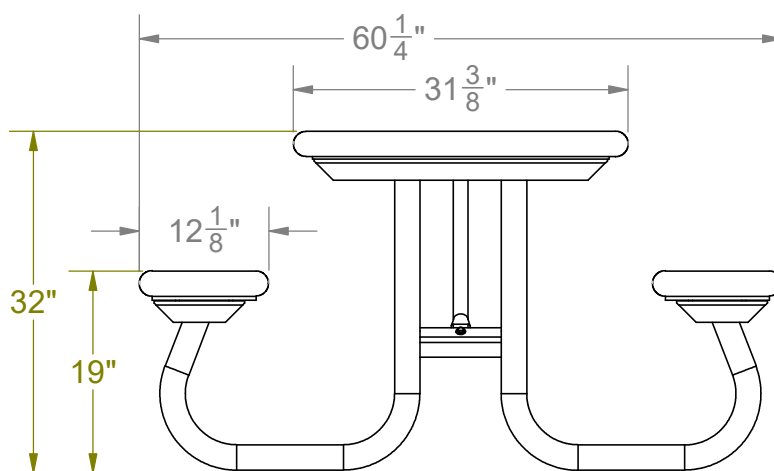

SIDE VIEW

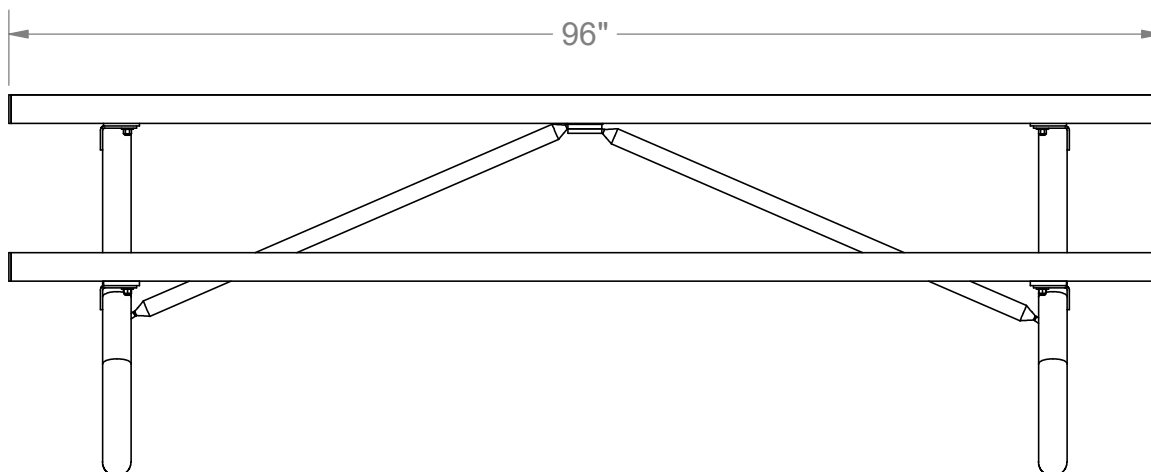

FRONT VIEW



Date: 7/26/2017

Rev: P1

Drawn: BDYE

Sheet: 1 of 8

PRODUCT NAME

8' PICNIC TABLE

MODEL NO.

4214-08

ITEM NO.	PART NUMBER	DESCRIPTION	QTY.
1	ASA-501-4214-08	TABLE FRAME ASSY	1
2	ASA-0504-1000-08	TABLE TOP PERFORATED 10GA ASSY	1
3	ASA-0504-4214-08-G	SEAT TOP PERFORATED 10GA ASSY	2
4	ASA-503-4214-08	SEAT FRAME ASSY	2
7	Preferred Wide FW 0.3125		38
8	HWLN14	1/4"-20 LOCK NUT	38
9	HWWF38112	3/8 X 1-1/2 FENDER WASHER ZINC	1
12	HBOLT 0.3750-16x1.25x1-N		16
5	HWHB382	3/8 X 2 GR 5 HEX BOLT	1
10	HWFLWA38	3/8" USS FLAT WASHER	32
11	HWLN38	3/8"-16 LOCK NUT STAINLESS STEEL	17
12	ASA-0500-4214-08-G	J-FRAME	2
13	RT-0019-1000-G	8' TABLE BRACE	2
14	91309A626	3/8"-16 x 1-1/4" HEX BOLT	2
15	HWFLWA516	5/16" USS FLAT WASHER	4
16	HWHN	3/8"-16 HEAVY HEX NUT	2

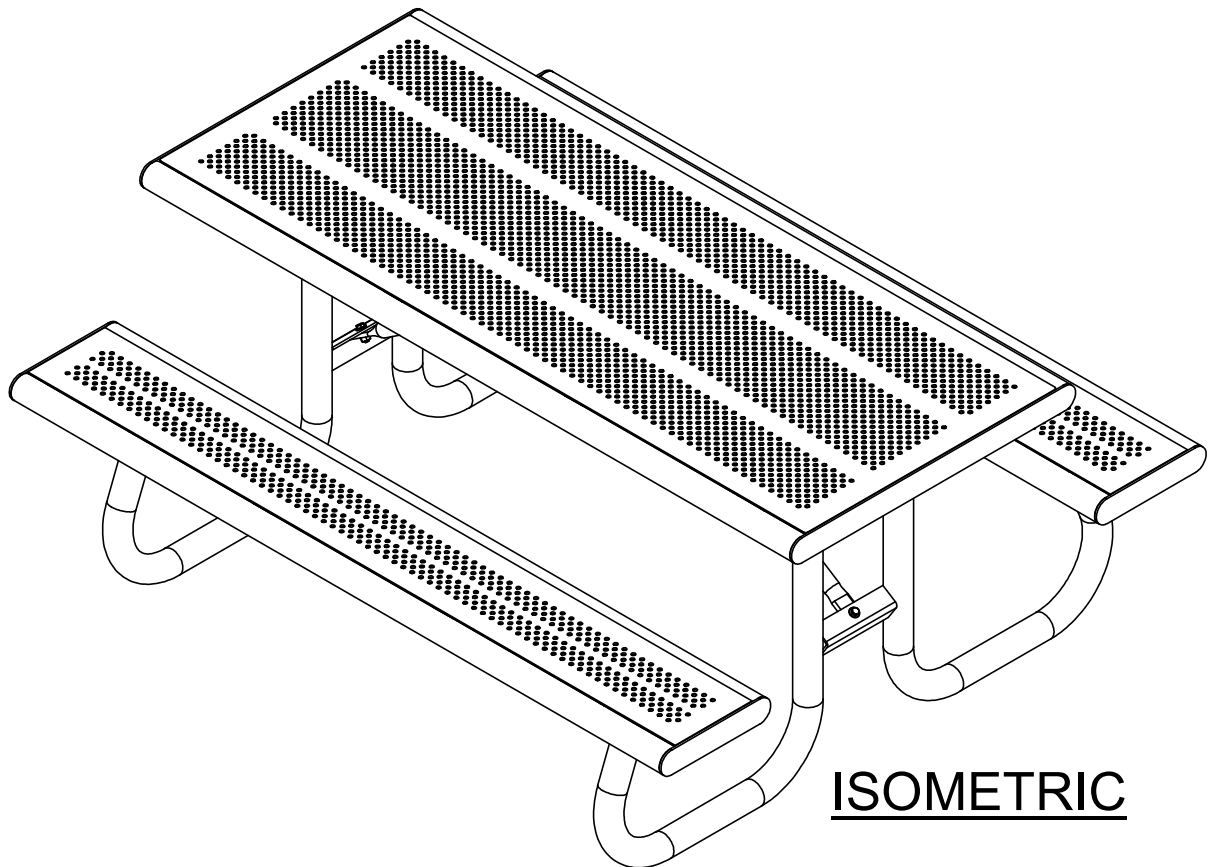

Date: 7/26/2017

Rev: P1

Drawn: BDYE

Sheet: 2 of 8

PRODUCT NAME

8' PICNIC TABLE

MODEL NO.

4214-08

INSTRUCTIONS:

1) Take both J-Frames Item ① and set on the ground about 74-3/4" apart as shown below.

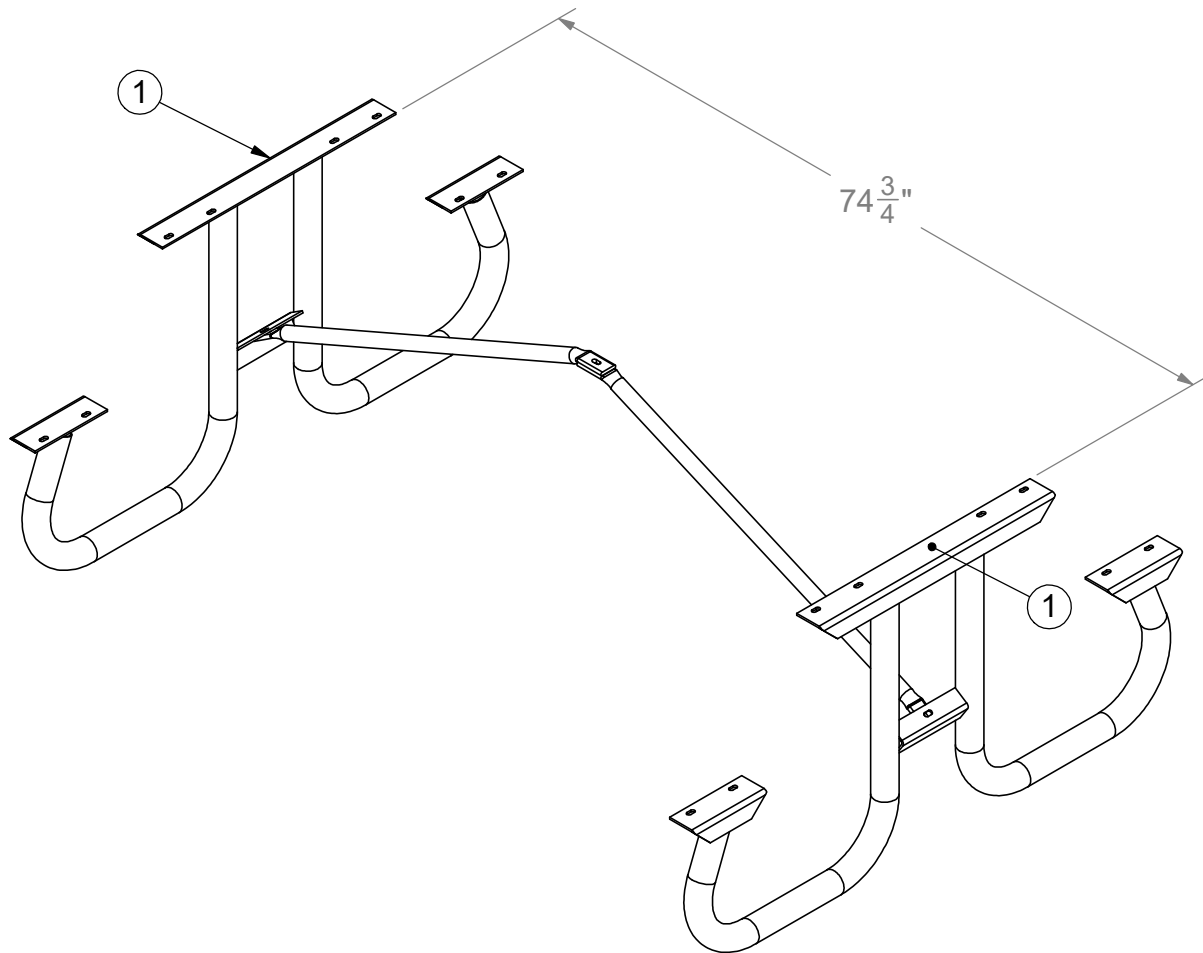

ISOMETRIC



Date: 7/26/2017

Rev: P1

Drawn: BDYE

Sheet: 3 of 8

PRODUCT NAME

8' PICNIC TABLE

MODEL NO.

4214-08

INSTRUCTIONS:

2) Take both Seat Frame Assemblies Item (4), Table Frame Assembly Item (2) and bolt to J-Frames Item (1) using 3/8"x 1 1/4" Hex Bolt Item (12), 3/8" washer Item (10) and 3/8" Nut Item (11) as shown below and on sheet #5.

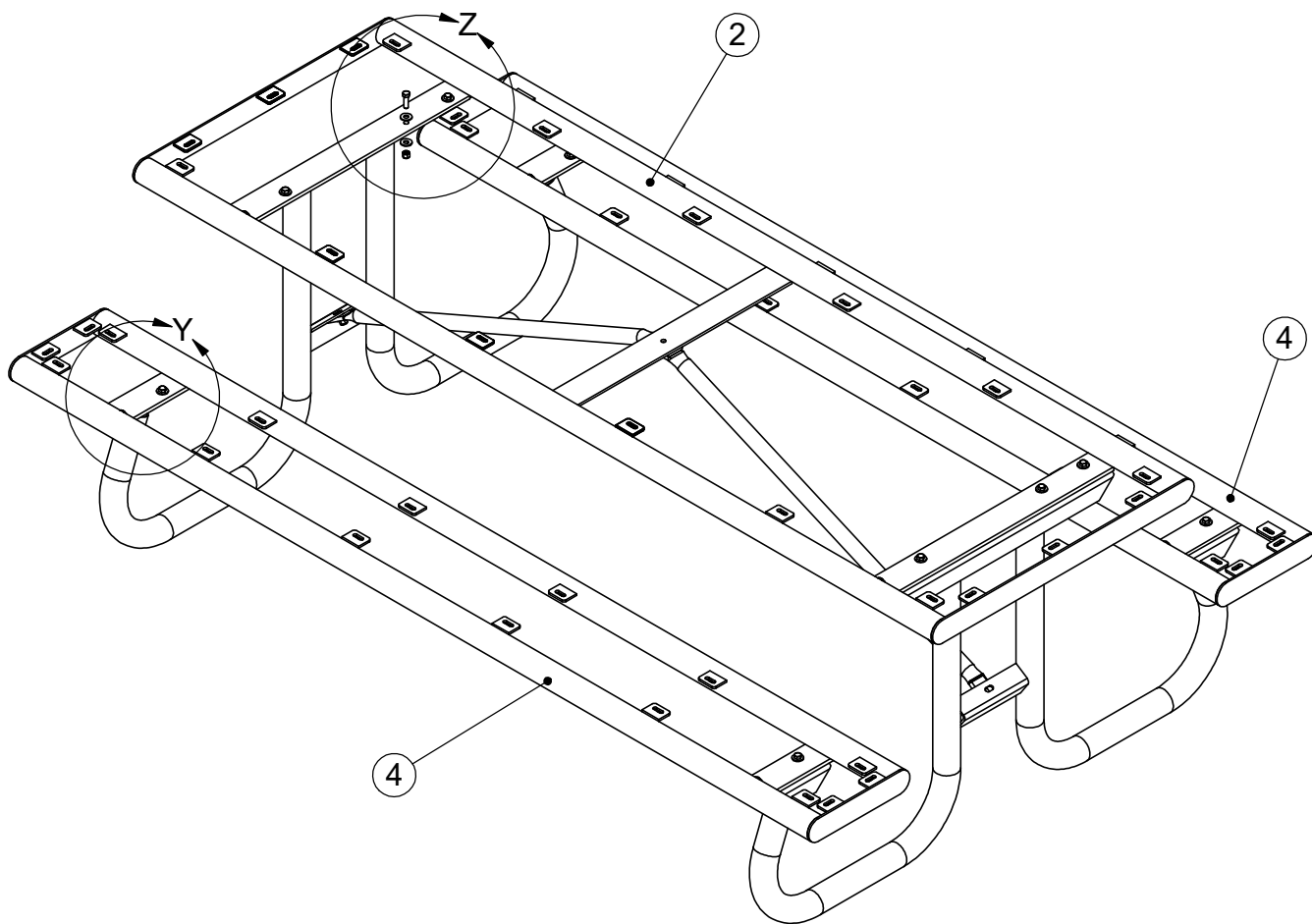

ISOMETRIC



Date: 7/26/2017

Rev: P1

Drawn: BDYE

Sheet: 4 of 8

PRODUCT NAME

8' PICNIC TABLE

MODEL NO.

4214-08

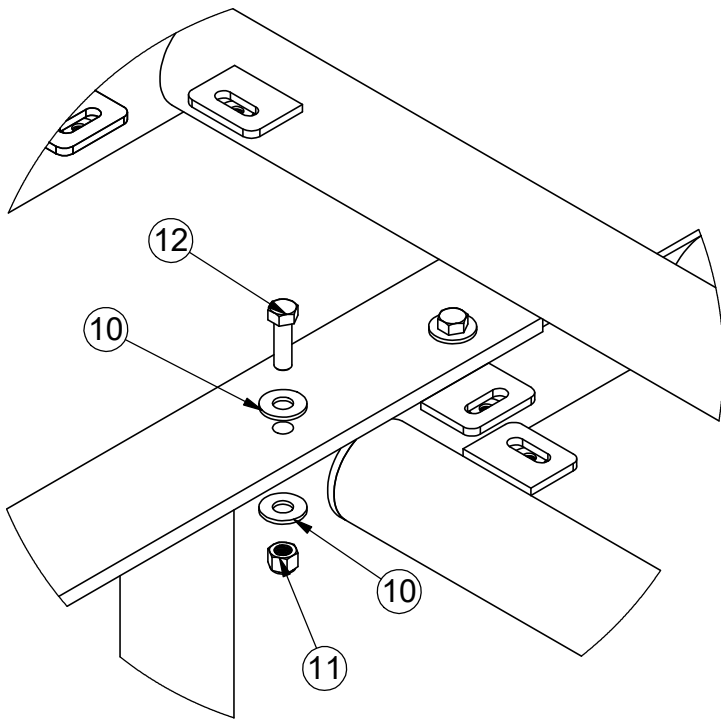

DETAIL-Z
FROM SHEET #4

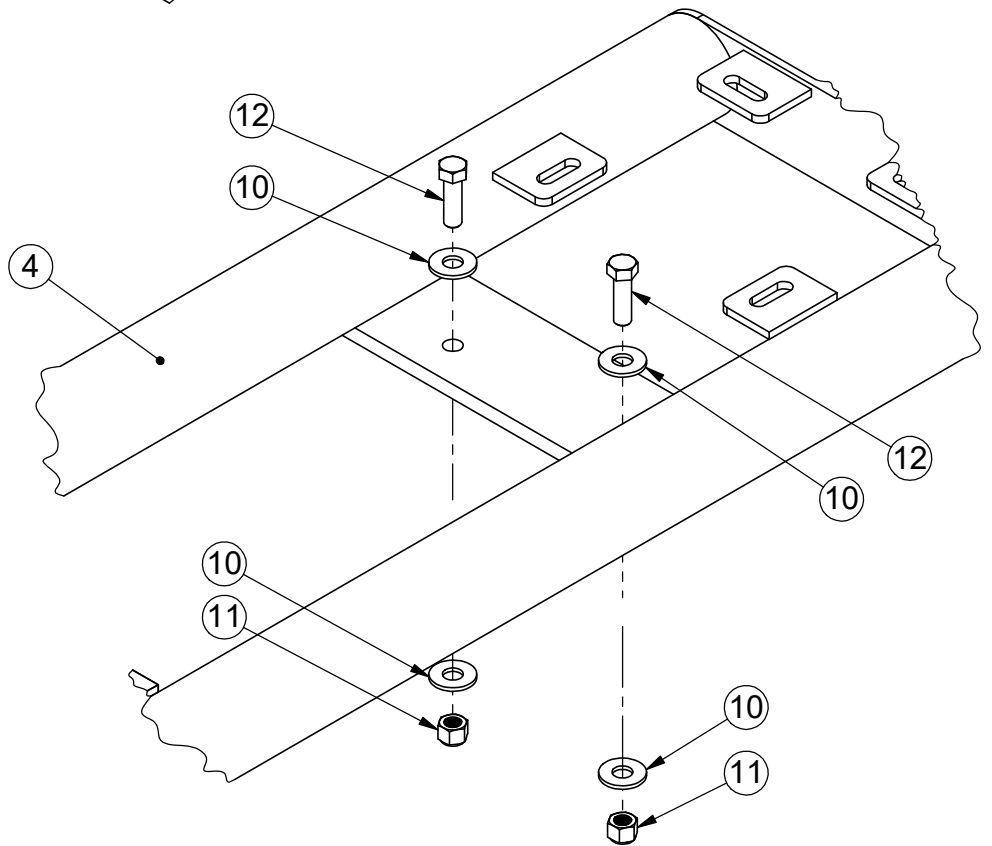

DETAIL-Y
FROM SHEET #4



Date: 7/26/2017
 Rev: P1
 Drawn: BDYE
 Sheet: 5 of 8

PRODUCT NAME

8' PICNIC TABLE

MODEL NO.

4214-08

INSTRUCTIONS:

3) Take both Seat Top Perforated 10GA. Assemblies Item (5), Table Top Perforated 10GA. Assembly Item (3) and bolt to Seat Frame Assemblies Item (4) and Table Frame Assembly Item (2) using 1/4" washer Item (7) and 1/4" Nut Item (8) as shown below and on sheet #7.

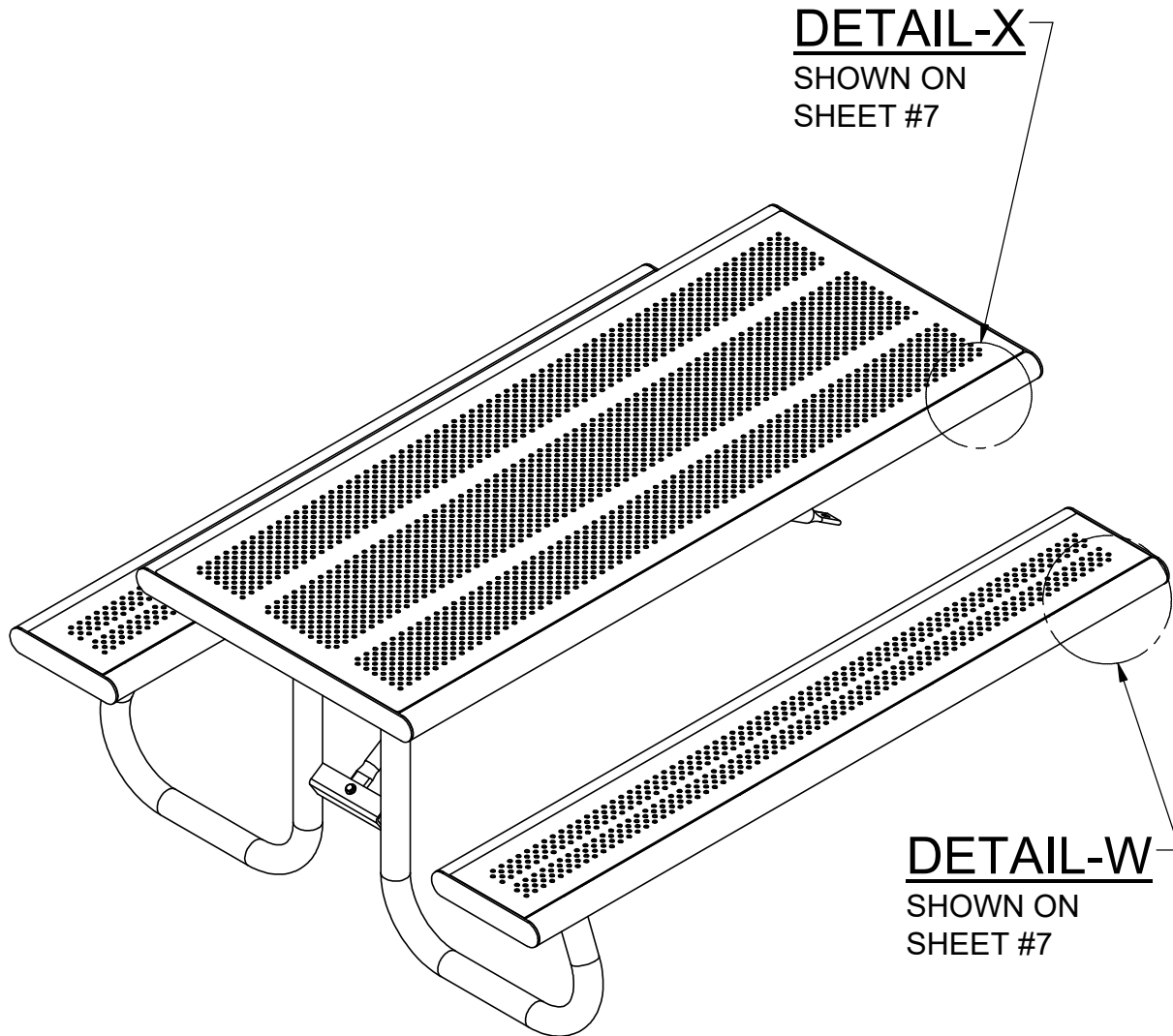

Date: 7/26/2017

Rev: P1

Drawn: BDYE

Sheet: 6 of 8

PRODUCT NAME

8' PICNIC TABLE

MODEL NO.

4214-08

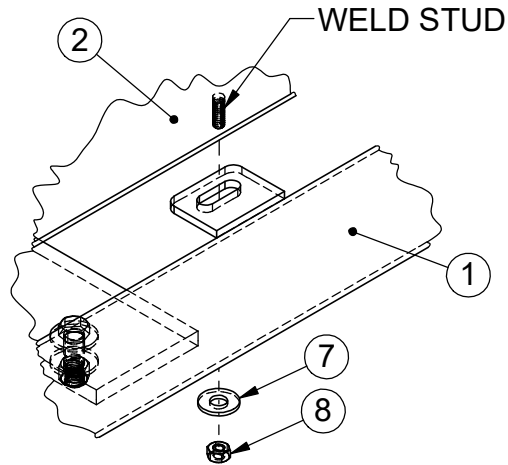

DETAIL-X
FROM SHEET #6

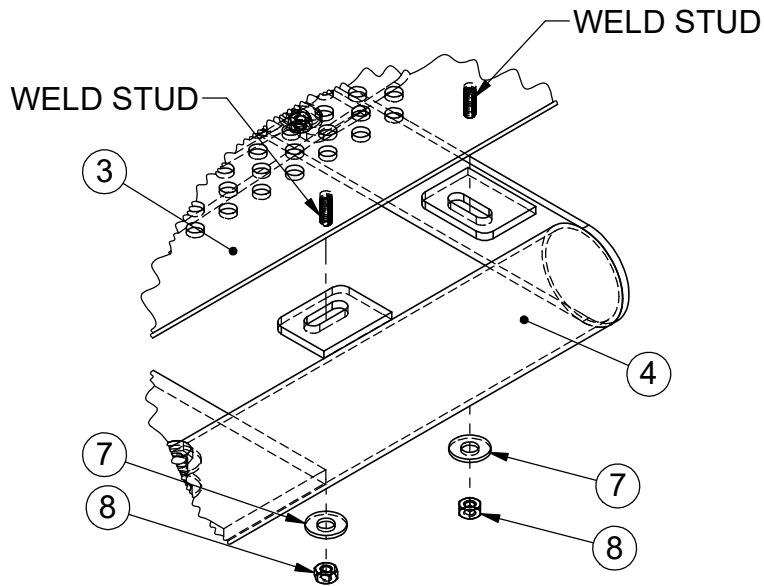

DETAIL-W
FROM SHEET #6



Date: 7/26/2017

Rev: P1

Drawn: BDYE

Sheet: 7 of 8

PRODUCT NAME

8' PICNIC TABLE

MODEL NO.

4214-08

INSTRUCTIONS:

4) Take 8' Table Brace Item (6), bolt to Table Frame Assembly Item (2) and to J-Frames Item (1) as shown below.

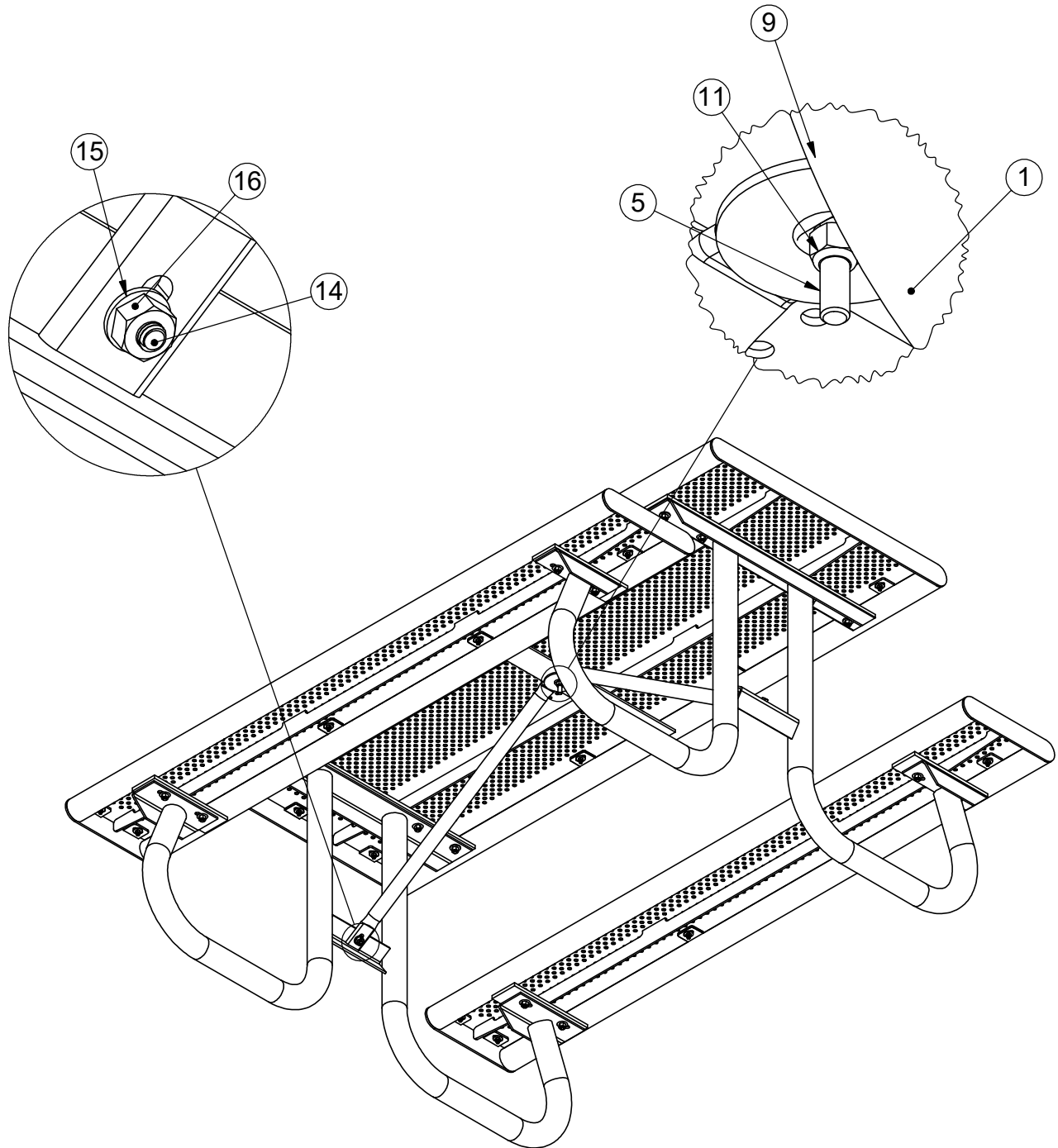

ISOMETRIC



Date: 7/26/2017
Rev: P1
Drawn: BDYE
Sheet: 8 of 8

PRODUCT NAME
8' PICNIC TABLE
MODEL NO.
4214-08